

Richland County WI Cemeteries



SCHMITT WOODLAND HILLS

April 13, 2010

**A Richland County WI
Cemeteries Presentation**

by David Thompson



Richland County Wisconsin Cemeteries

Dave Thompson

Richland County Wisconsin Cemetery Researcher

Email: dthomps@mwt.net

Website

<http://freepages.genealogy.rootsweb.com/~richlandwi>

MANY DIFFERENT SOURCES

VITAL RECORDS at Richland County Court House

Marriage & Death Records Mainly

RICHLAND COUNTY HISTORY ROOM

HERE THEY SLEEP (Township cemeteries)

Marriage Index

Census Indexes (1850-1900)

Richland County History Books (1884, 1906 & 1986)

Richland County Honor Roll World War I

Other History Room Pub/Articles/Newspapers/Platbooks/etc

LOCAL NEWSPAPERS

Obituaries (mainly) (Margaret Jordan's Index to 1900)

RO-Obits (1970 - today my collection)

TALES THE TOMBSTONES TELL - Steven Fogo

OTHER WEBSITES

Sons of the Union Veterans of the Civil War

Family Search (Latter-Day Saints)

ROOTSWEB (Ancestry.com family)

Newspaper obits.

Funeral Homes (Both Local and afar)

GOOGLE IS MY FRIEND!

PESONNEL CONTACTS

Veterans

- Virgil Matz (Civil War)

- Loretta McCarthy (All Richland Country veterans)

Family researcher via email (world wide)

And many other people that have help me along the way!

CEMETERY DATABASE Multiple Records View

Rec	Lname	FMname	Maiden	Cemetery	BYea	DYea
5195	Thompson	Rena V.	Baker	RCtr	1867	1939
7068	Thompson	Richard Dwayne		RCtr	1939	1939
28602	Thompson	Richard Francis		Czech Nationa	1912	1989
5202	Thompson	+Richard Kent		RCtr	1944	1956
22346	Thompson	Robert E., Dr.		Sextonville	1864	1917
24910	Thompson	Roger Eugene		Sextonville	1953	2007
22559	Thompson	Roy Gilbert		Sextonville	1886	1949
22518	Thompson	Ruby May	Thompson	Sextonville	1901	1974
22567	Thompson	Ruth L.	Carpenter	Sextonville	1924	1974
12993	Thompson	Ruth S.	Sawyer	Button	1890	1989
10303	Thompson	Samantha Ellen	Stetler	Basswood	1858	1936
17064	Thompson	Samuel J.		Five Points	1889	1966
9142	Thompson	Scott Earl		Saint Anthony	1900	1952
5187	Thompson	Shirley Lorrain	Drury	RCtr	1935	1968
20139	Thompson	Silas Newton		Pleasant Hill	1851	1880
7471	Thompson	Stella Alma	Hagenstone	RCtr	1918	1996
9143	Thompson	Stella Elizabet	Leimkuehler	Saint Anthony	1897	1980
22560	Thompson	Stella May	Gray	Sextonville	1892	1931
7080	Thompson	Suzanne Mae		RCtr	1957	1958
35291	Thompson	Suzette Marie	DeVault	Concord	1944	1978



Richland County, WI Cemeteries WI Cemeteries

<http://freepages.genealogy.rootsweb.ancestry.com/~richlandwi>

reb.ancestry.com/~richlandwi



Richland County, WI Cemeteries

This page updated: March 13, 2010

What's New

[Click this link to see What's New](#)

Richland Observer Obituary Index

[Click this link for 1970-ToDate Obit Index](#)

Richland County & Related Research Links

[Click this link for other Links](#)

[Richland County Cemeteries Additional Information](#) New January 13, 2010

- [Ash Creek Cemetery](#)
- [Ash Ridge Cemetery](#) AKA Putnam Cemetery
- [Bailey-Lowry Plot](#)
- [Basswood Cemetery](#)

- [Pleasant Ridge Cemetery - Bloom](#)
- [Pleasant Ridge Cemetery - Willow](#)
- [Pugh Plot](#)
- [Richland Center Cemetery](#) (With Photographs)
- [Richland City Cemetery](#)

- [Woodstock Cemetery](#)
- [Wright Plot](#) AKA Cox, Upper Byrds Creek and Woodland Plot
- [UNKNOWN \(cemetery not listed\) & Various burial Sites in Richland County, WI](#)

0642 15

since September 25, 2001

PICO
SEARCH

Search

[Site Search by PicoSearch .Wisp](#)

Email Corrections/Additions to: dthompso@mwt.net



Free Web space
provided by
RootsWeb

Use, Copyright and Ownership: Individuals and groups can use these volumes freely but without use for their financial gain. The full ownership is retained by the author.



Richland Center Cemetery



Thompson's **Richland Center Cemetery**

Richland Center, Wisconsin
Richland Township, Richland County, Wisconsin USA

Photographs taken in 1999-2001 uploaded in 2009 (Newer photos to be added)

[Click on Links on Surname pages to view photographs](#)

(Last Updated April 5, 2010)

(Surname Pages Updates Maybe Different - Check Date on Page)

Surnames

[A](#) [B](#) [C](#) [D](#) [E](#) [F](#) [G](#) [H](#) [I-J](#) [K](#) [L](#) [M](#) [N-O](#) [P-Q](#) [R](#) [S](#) [T](#) [U-V](#) [W-X-Y-Z](#)

[Maiden Name X-Ref.](#) [Veterans](#) [Cemetery Guide](#) [Cemetery Section/Lot Maps \(Updated 8/8/2009\)](#)

Email Corrections/Additions to: dthomps@mwt.net

Use, Copyright and Ownership: Individuals and groups can use these volumes freely but without use for their financial gain. The full ownership is retained by the author.

[Cemetery location map by Dennis Cook](#)

[Lon's Richland Township Page](#)

[Go Back to Richland County WI Cemeteries Main Page](#)

Thompson's **Richland Center Cemetery** Richland Center, Wisconsin

Richland Township, Richland County, Wisconsin USA

Surnames T's

(Last Updated April, 5, 2010)

SURNAME	Given Name	MAIDEN-OTHER		Section	Lot	Photos
TADDER	Albert		1872 1929 04-21-1872 02-01-1929	C.P.	107	Add1 Add2
Son of Joel Patton & Betsey Ann (Sires) Tadder.						
Note: Temporary marker has been removed!						
TADDER	Amarda Harriett	ANDERSON	1871 1944 07-15-1871 03-06-1944	O.P.4	76	Add1
Married Henry E. Tadder on May 1, 1892.						
Daughter of Abraham & Rebecca Ann (Blythe) Anderson.						
TADDER	Beatrice M.		1904 1907 10-08-1904 06-01-1907	O.P.4	76	Add1
Daughter of Henry E. & Amarda Harriett (Anderson) Tadder.						
TADDER	Bernard Benjamin		1915 1965 06-15-1915 10-03-1965	Block G	33	Add1
MS with Cardell. Married Irvine "Cardell" Sandmaire.						
Son of Jesse M. & Cora Belle (Miller) Tadder.						

Using Ctrl-F Find on this Page

Find: Previous Next  Options ▾ 4 matches

THOMPSON	Raymond H.		1909 1978 05-27-1909 07-24-1978	C.P.	33	Add1
Pvt US Army - World War II						
Married Faustine L. Peckham-Bower-Cockroft on July 11, 1947.						
Son of Emory & Bertha Thompson.						
THOMPSON	Rena V. BAKER		1867 1939	O.P.3	15	Add1 Add2 Add3 Add4
LS with her parents and her brother Fred & Harry BAKER.						
Married _____ Thompson.						
Daughter of William W. and Vira L. (Pease) Baker. Small="Rena"						
THOMPSON	Richard Dwayne		1939 1939 11-07-1939 11-07-1939	O.D.	127	Add1 Add2 Add3 Add4
Son of Keith Loren & Stella Alma (Hagenstone) Thompson.						
THOMPSON	Richard Kent		1944 1956 05-31-1944 07-14-1956	L.C.	13	Add1 Add2 Add3
Son of William Frank "Bill" & Joyce Elaine (Briggs) Thompson. "Son"						

Thompson's **Richland Center Cemetery**
Richland Center, Wisconsin

Richland Township, Richland County, Wisconsin USA

Surnames T's
(Last Updated April, 5, 2010)

(Click on Links to view photographs)

SURNAME	Given Name	MAIDEN-OTHER	Section	Lot	Additional Photos
THOMPSON, Richard Kent			1944 1956 05-31-1944 07-14-1956 L.C.	13	Add1 Add2 Add3
Son of William Frank "Bill" & Joyce Elaine (Briggs) Thompson. "Son"					

Click to see marker

THOMPSON, Richard Kent			1944 1956 05-31-1944 07-14-1956 L.C.	13	Add1 Add2 Add3
Son of William Frank "Bill" & Joyce Elaine (Briggs) Thompson. "Son"					

Lot 13

Lawn Circle



**How to I find the location
and get to this Cemetery ??**

RICHLAND COUNTY WISCONSIN

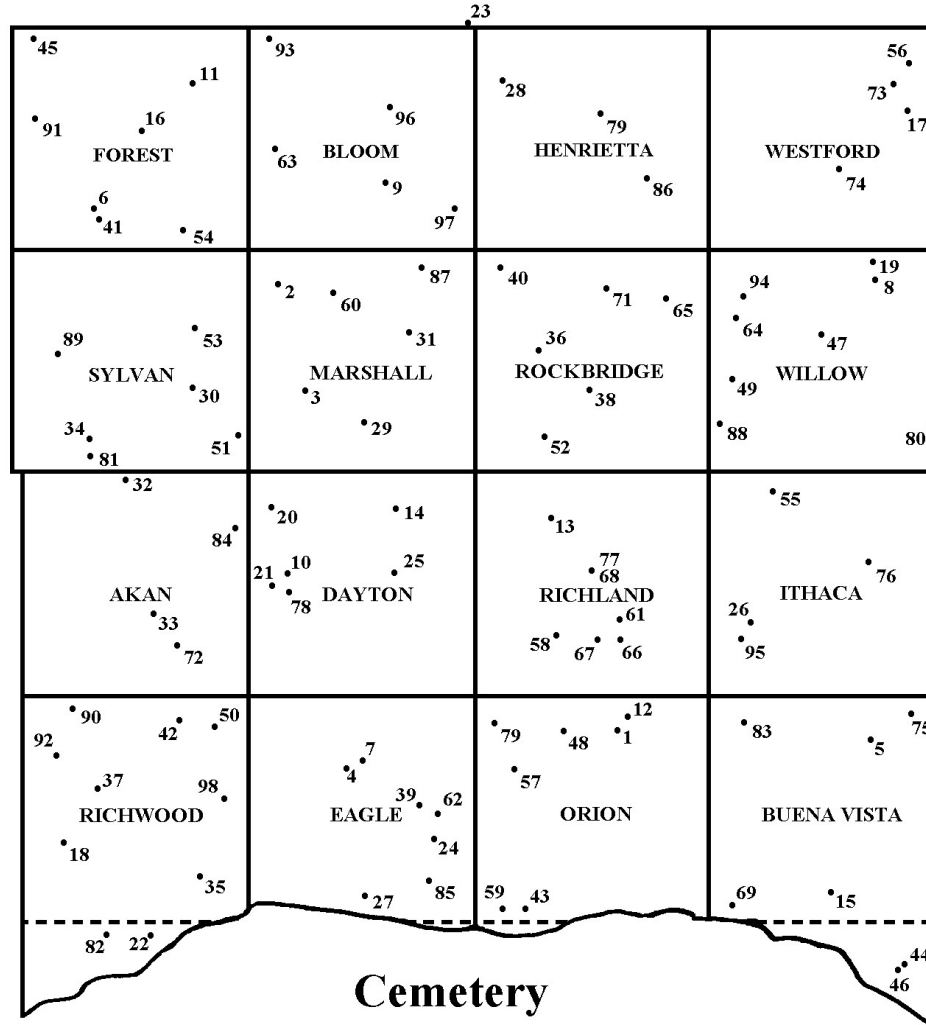

Cemetery Locations

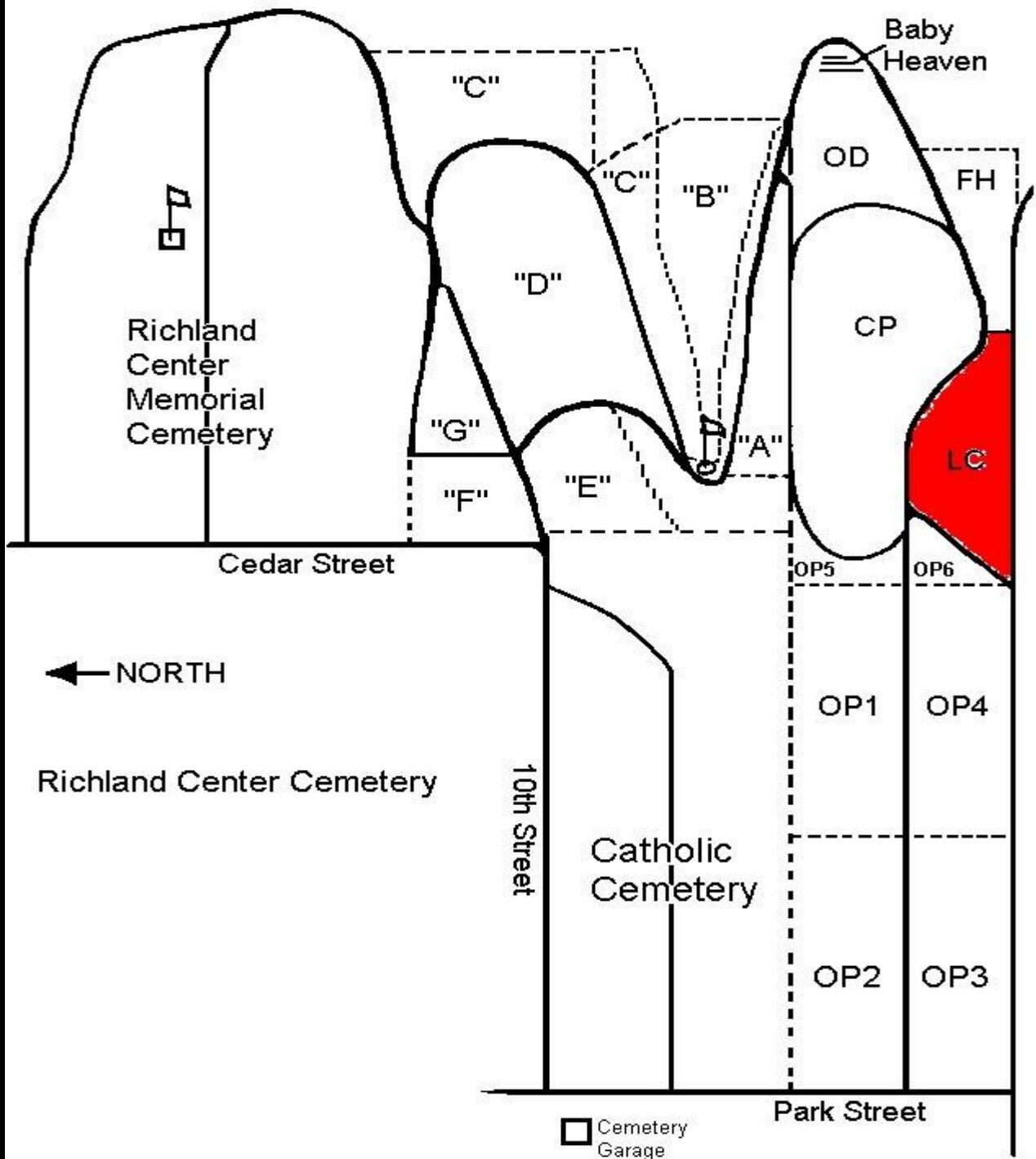

Richland Center Cemetery
Cemetery Section/Lot Maps
Lawn Circle (L.C.)

N
+
W

E
+
S

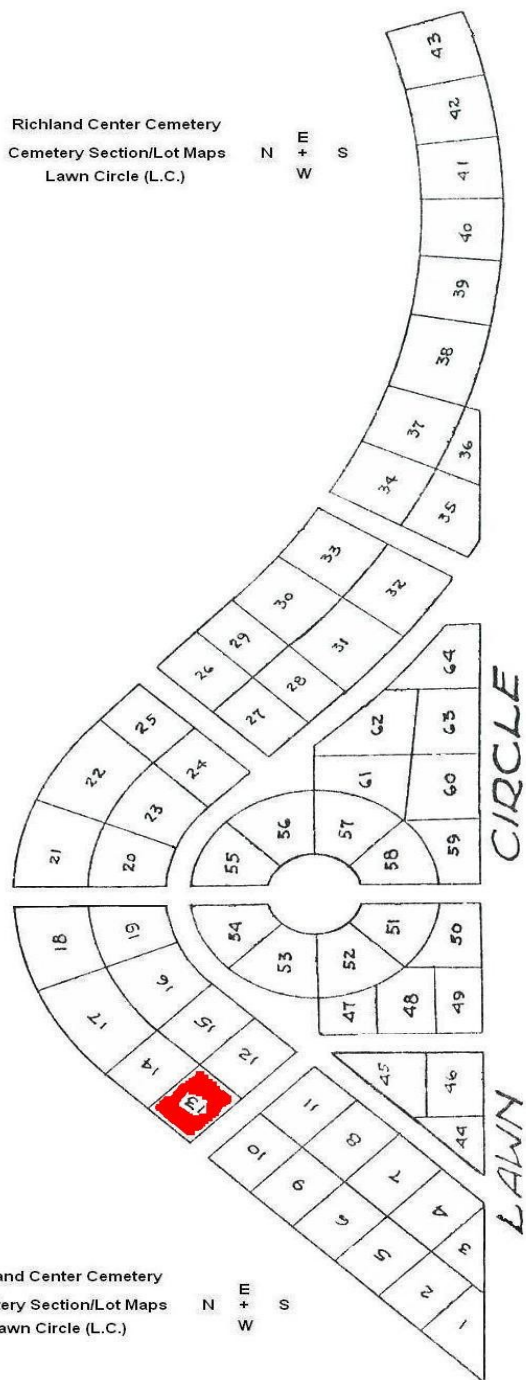

Richland Center Cemetery
Cemetery Section/Lot Maps
Lawn Circle (L.C.)

N
+
W

E
+
S



SECTION **LC** LOT NO. **13** NAME OF GRAVEE **Wm. Shireman**
 ADDRESS _____
 DATE OF SALE _____ PRICE OF LOT _____ AREA **90 FT 300** MONUMENT _____
 REMARKS **No record of Paym't. of Lot.**



DATE OF BURIAL	NAME OF INTERRED	AGE	V.	H.
1928	<i>M</i> Geraldine Thompson			
<i>1922</i>	<i>G.</i> Madeline Berlin			
1902	<i>F.</i> Minnie L. Shireman			
1940	<i>F.</i> Wm. Shireman			
<i>7-16-56</i>	<i>Richard Kent Thompson</i>			

<i>A</i>	<i>2</i>
<i>J</i>	<i>B</i>
<i>H</i>	<i>C</i>
<i>G</i>	<i>D</i>
<i>F</i>	<i>E</i>

SECTION **LC** LOT NO. **13** NO. OF GRAVES _____ NAME OF LOT OWNER **Wm. Shireman**

LC Lot 13 Wm. Shireman

DATE	ITEM	DEBIT	✓	CREDIT	BALANCE	DATE	ITEM	DEBIT	✓	CREDIT
1/9/22	O.Gr.	10 00								
1/9/22	Cr.#300			10 00						
9/22/28	O.Gr.	10 00								
9/22/28	Cr.#1209			10 00						
8/16/40	O.Gr.	10 00								
8/16/40	Cr.PFH #6961			10 00						
<i>7-16-56</i>	<i>R.H.</i>	<i>20 00</i>								
<i>7-16-56</i>	<i>Cr.P.H.</i>			<i>20 00</i>						

418 1925 342 P.M.

Warranty Deed

No. 68008

CEMETERY LOT FROM
CITY OF RICHLAND CENTER TO

Mrs. Rosetta Dexter
The West $\frac{1}{2}$ of
Lot 83 Crescent
Block Place

Register's Office }
Richland County } ss

Received for record this 3rd

day of April A.D. 1925

at 3⁴⁵ o'clock P M and recorded

in Vol 74 of Deeds page 88

J. M. Shrieman
Register of Deeds
Douglas Shrieman
Dep.

W. A. Haney
June Rock

Know All Men by These Presents:

That The City of Richland Center, of Richland County, and State of Wisconsin, in consideration of the sum of (\$56.00)
Fifty Six & 00/100 Dollars in hand paid by Mrs Rosetta Dexter

of Richland County, State aforesaid, the receipt whereof is hereby acknowledged, do, by these presents, give, grant, bargain, sell

~~to Mrs. Rosetta Dexter~~
forever, a certain piece of land, including the perpetual care of same by the said city, described as follows, to-wit: ^{The W. $\frac{1}{2}$ of} Lot
Number 83 Crescent Place in Block Number _____ as laid off in Blocks Twenty-
nine and Thirty, in Section sixteen, Town ten, North of Range one, East together with all privileges for the burial of the dead, and
for no other purposes, and to be governed by all ordinances, rules and regulations now in force or hereafter adopted by said city
governing the same.

In witness whereof the said city has caused these presents to be signed and its seal hereinto affixed this 5th
day of March 19 25.

In Presence of

CITY OF RICHLAND CENTER, WIS. (SEAL)

Wm. H. Spurr
J. S. Penick

By W. H. Spurr Mayor
Attested: Aug. C. Luckey Clerk

STATE OF WISCONSIN, }
Richland County } ss

Personally came before me this 5th day of March A. D., 19 25
the above named W. H. Spurr Mayor, and Aug. C. Luckey Clerk
of said City of Richland Center, to me known to be the persons who executed the foregoing instrument and acknowledged the
same by virtue of the authority of their respective offices and for the uses and purposes therein set forth.

Francis L. Brewer
Notary Public, Wis.
My Commission expires July 18, 1926.

Thursday, July 19, 1956

Swimming Pool Accident Causes Boy's Death

Richard Kent Thompson, 12, died at the Richland hospital on Saturday, July 14th at 7 p.m. from injuries received at the swimming pool early in the afternoon. Kent was injured at the small slide; his head having struck the bottom of the pool as he dived off the slide. He continued playing in the pool but soon complained of a headache and given an aspirin. He continued in the pool and again complained of a headache. Taken to a doctor he was transferred to the hospital where he passed away in a short time.

Kent was a student, attended the Gillingham school while his parents resided near there, but of late he has resided in Allison Park just north of the city limits.

The lad was born in Richland Center May 31, 1944. He was well liked by his schoolmates and his untimely death is deplored by one and all.

Surviving are his father, William F. Thompson, of Allison Park, his mother, Mrs. John McBain, of Milwaukee, a brother, David Brent Thompson and his grandfather, Don Briggs, of Richland Center.

Funeral services, with Rev. Kenneth Kohl, pastor of St. John's Lutheran church, were held Tuesday at the Pratt Memorial Chapel and burial made in the city cemetery.

Kent Thompson, 12, Dies From Injury

Kent "Butch" Thompson, 12, died Saturday evening at about 7:00 o'clock at the Richland Hospital from an injury he sustained earlier in the day at Krouskop Park. While it is not definitely known just in what manner he sustained his injury, the doctor's report is that Kent "evidently struck his head on sand bottom after going down slide." He had been swimming at the pool during the day, and the lifeguards at the pool report that the youth came to them complaining of a headache and requested some aspirin.

Later, Kent's brother, David, reported to the lifeguards that the boy was still in much pain, and he was then removed to the hospital.

Sunday morning an examination by a pathologist resulted in the following as the cause of death: "Intraventricular hemorrhage due to ruptured branch of basilar artery system due to head and neck injury."

He is survived by his father, William Thompson, Allison Park, with whom he made his home; his mother, Mrs. John McBain, Milwaukee; a brother, David Brent, and his grandfather, Don Briggs, Madison.

Funeral services were held Tuesday afternoon at the Pratt Memorial chapel with the Rev. Kenneth Kohl officiating. Burial was in the city cemetery.

Richard Kent
THOMPSON

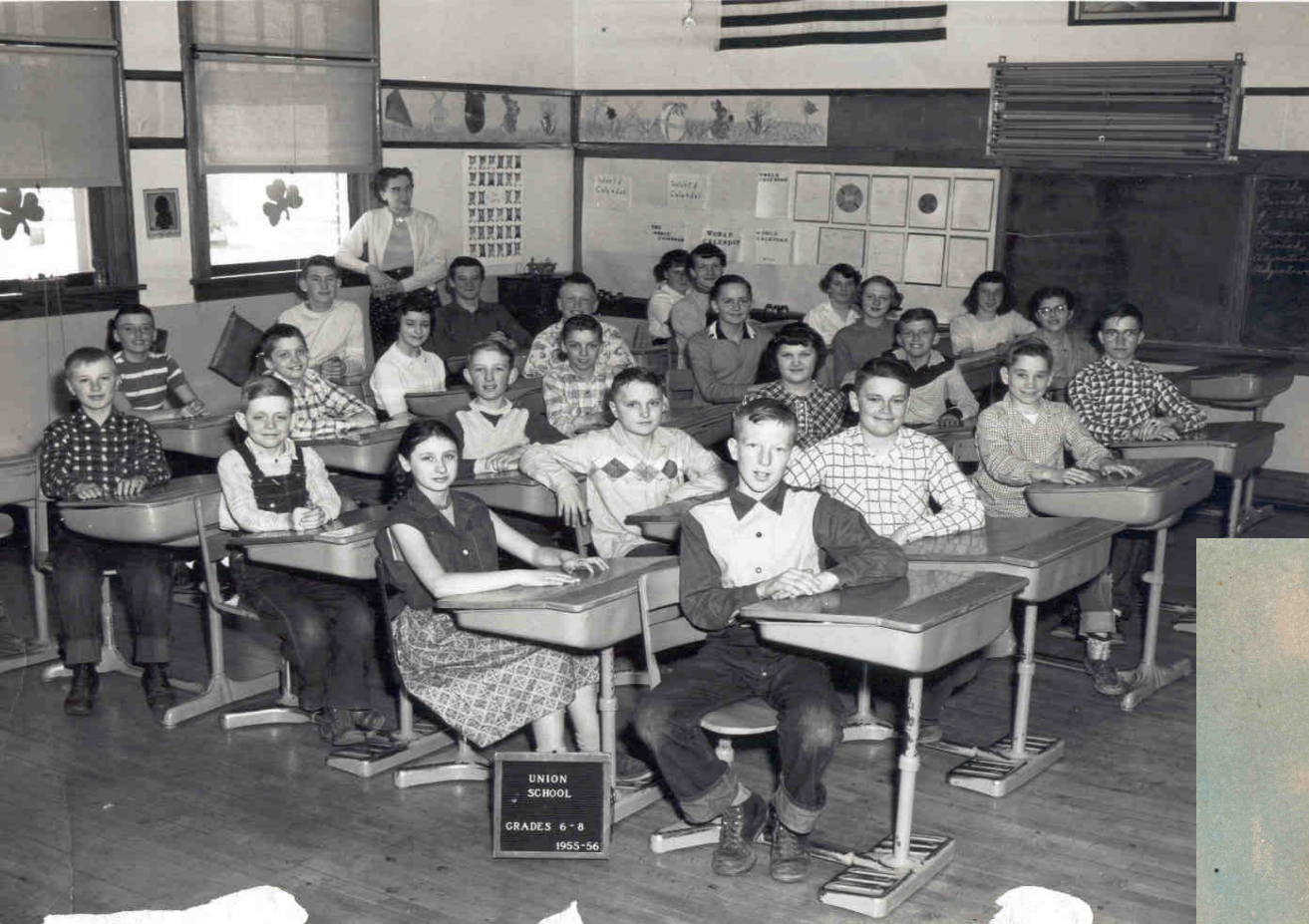

Union School Grades 6-8 1955-1956

Gillingham, WI

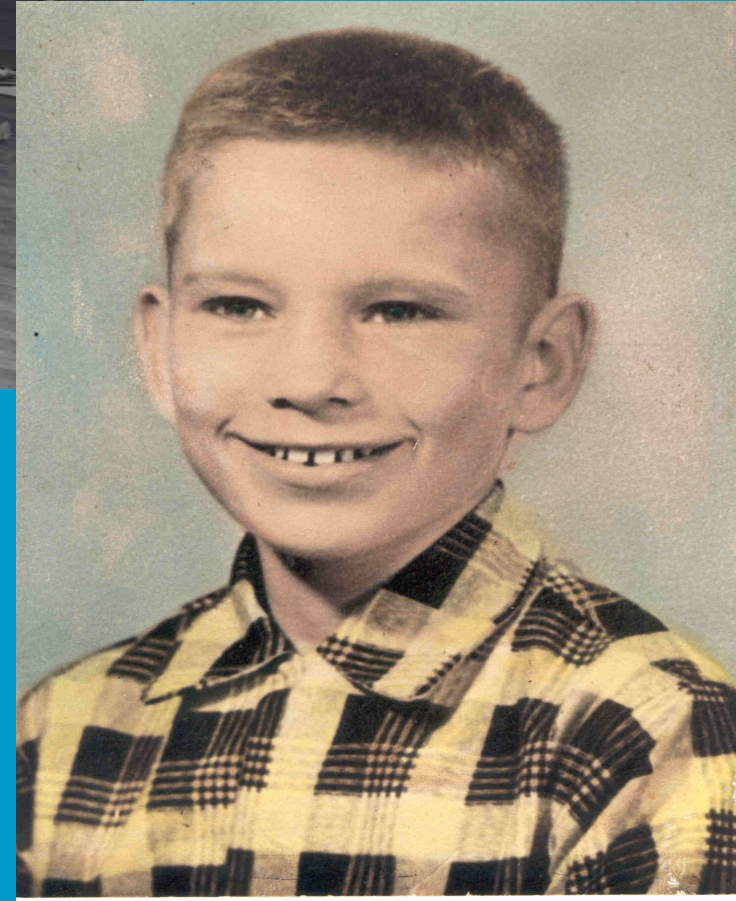



CLEANUP Sometimes a little trimming is needed!



CLEAN UP

Original

Sweep

Pull Weeds

Take the Picture





C
L
E
A
N
U
P



TOP: Putty Knife & Sweep

BOTTOM: Water, soaking & brush



CLEAN UP

**A little help from a
Charcoal Pencil.**

DARWIN O. CHANDLER
BORN IN ERIE CO. N. Y.
APRIL 10. 1829.
MOVED TO RICHLAND CO. WIS.
IN 1854
WHERE HE DIED APRIL 30. 1892.

**Yes, that is a lot
better for reading
and photographing!**

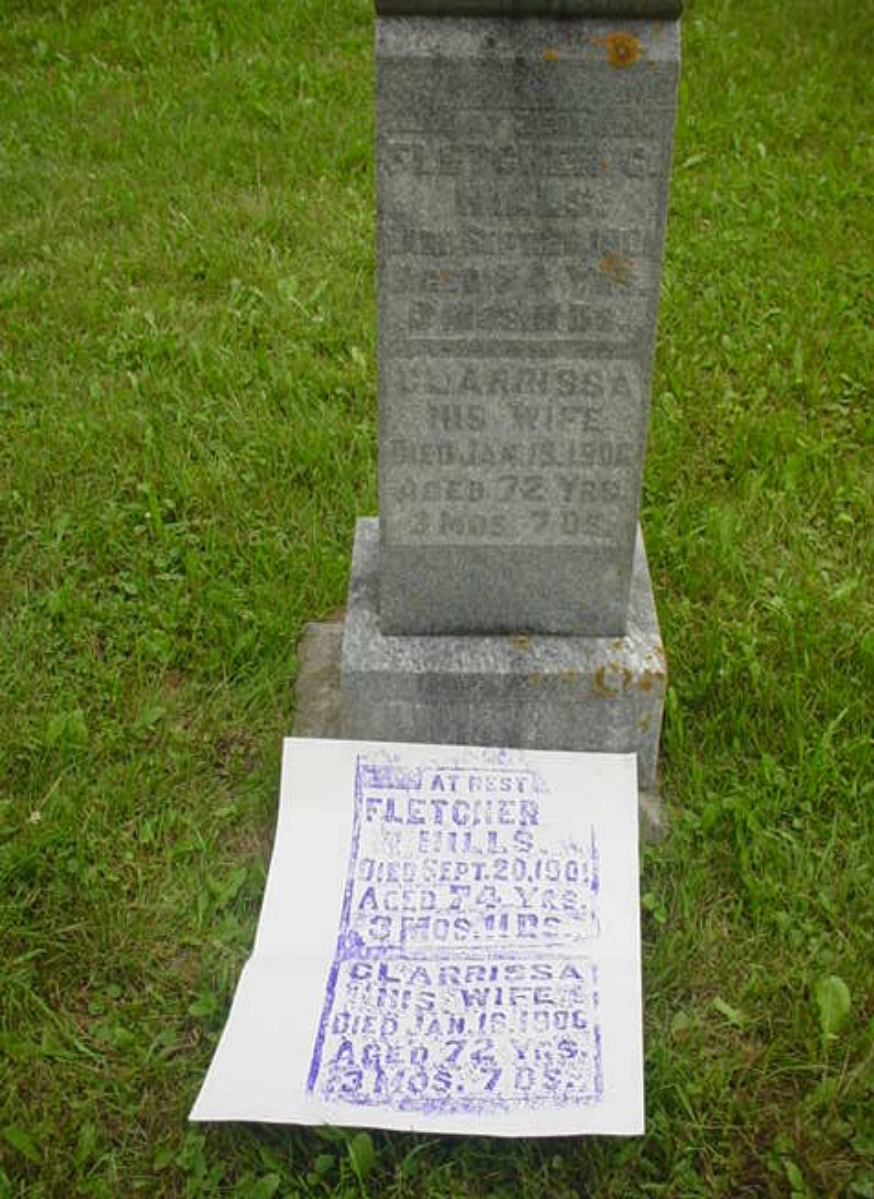

CLEANUP Sometimes a rubbing is needed.



STYLES OF MARKERS



More STANDARD MARKERS





SPECIAL MARKERS



More SPECIAL MARKERS



S
Y
M
B
O
L
S



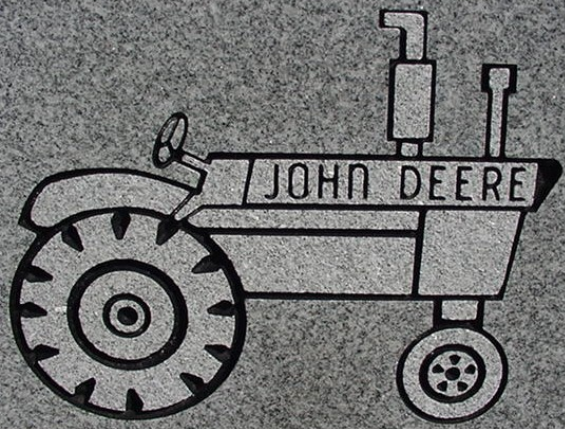

ICONS



LAND FOR THE BUTTON CEMETERY
GIVEN IN 1848 BY
LEONARD BUTTON 1820 - 1889
FATHER OF
ALBERT H. BUTTON 1858 - 1928
FATHER OF
MILTON H. BUTTON 1896 - 1967

IN MEMORY OF
FRANK BURDISK
WHO LOST HIS LIFE
WHILE PERFORMING
HIS DUTY AS BRAKE-
MAN, AT ST. PAUL,
MINN.

IN MEMORY OF
SAMUEL L. TANNER
BORN IN RICHLAND CO.
SEPT. 21, 1875
MARRIED TO
MISS DORA FRY
DECEMBER 25, 1898
DIED ON LITTLE WILLOW
JAN. 26, 1902.
ABSENT NOT DEAD

TANNER

Additional Information

FRANCIS W. LUNENSCHLOSS
DEC. 17, 1941
GOLFER WITH UNPLAYABLE LIE

SON OF
CHARLES & GYNETH
GRANDSON OF
CHARLES & FRANCES
GREAT GRANDSON OF
WILLIAM & ELIZABETH
BROTHER TO
MARYANNA RICHARD
JULIE STEVEN
NEPHEW TO
STELLA & LEO POKORNEY
COUSIN TO
FRANK & GERTIE LUNENSCHLOSS



**Photographing
the
Photograph**

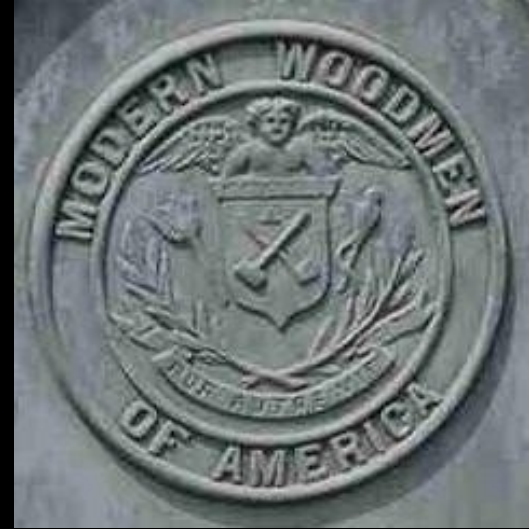

Societies & Organizations



D
A
M
A
G
E
D

O
R

M
I
S
S
I
N
G





DAMAGED MISSING REPAIR



Richland County Veterans

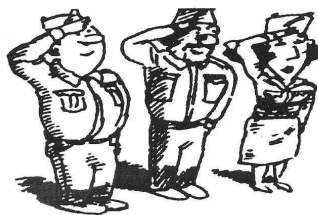

Richland Co WI Cemeteries – Veterans Counts

Revolutionary War 1775-1783	0
War of 1812 - 1814	19
Mexican War 1846 - 1848	18
Civil War 1861 - 1865	959
Spanish American War 1898	16
World War I 1917 - 1918	531
World War II 1941 - 1945	1237
Korean War 1950 - 1953	202
Vietnam War 1964 -1973	80
U.S. Veterans not in Wars listed	278

Total of 3,340

----- Combinations -----

War 1812 & Civil War	1
Mexican & Civil War	5
World War I & II	13
WW2 & Korea	37
WW2, Korea & Vietnam	12
Korea & Vietnam	7

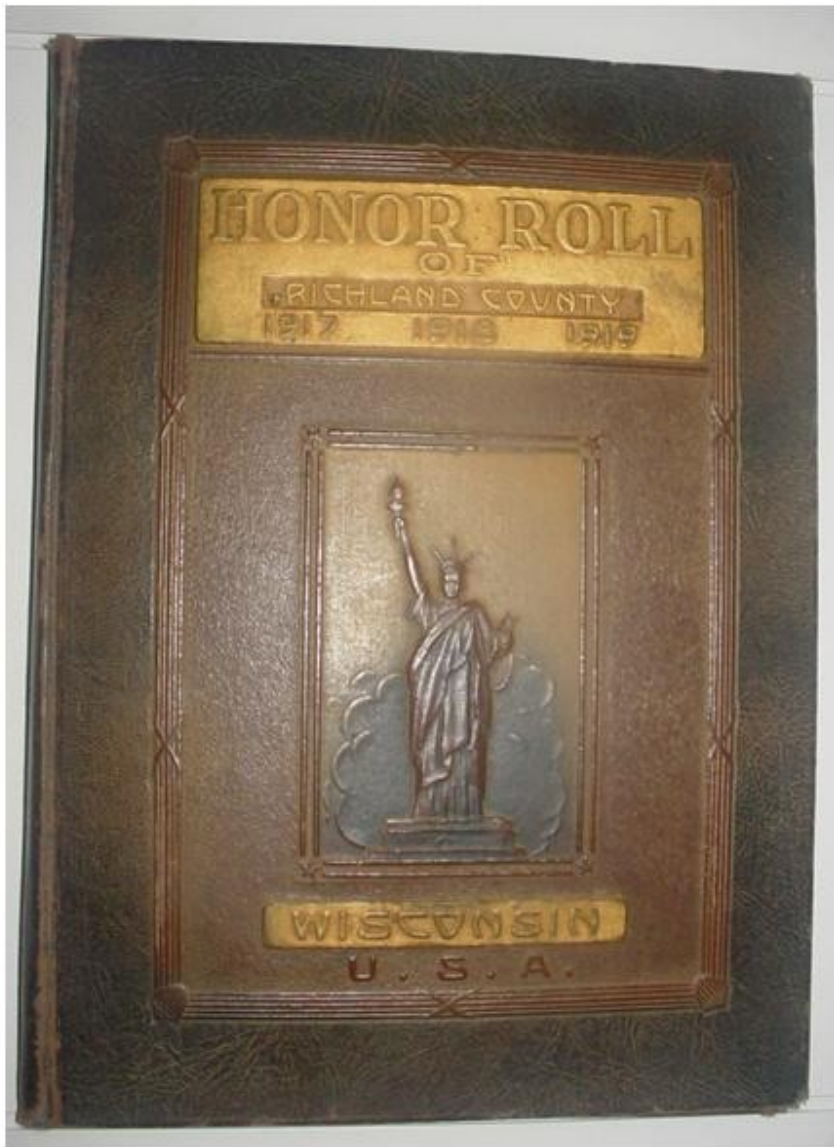

**Richland County Honor Roll
World War I Book**

Richland County Honor Roll
1917 1918 1919
Of Those Who Died In The Service Of Their Country

Justin W. Dake *	Richard E. Ryman *
Jay C. Frost	George Earl Brainard *
Pearl B. Waldsmith *	Floyd Willard Manley *
David Glen Jones	Frank M. Walsh *
Walter Koerth	Kenneth N. Cunningham *
Hartzel P. Alderman *	Howard E. Felton *
William Shea *	James P. Sullivan
Carl Thomas Gunnill *	Edward M. Sullivan
Gale Welton	Jay Hollis Keys *
Bayard C. DeHart *	Joseph Edward Jelinek *
John L. McNamara *	Frank Kostka *
Hubert J. McNamara *	Samuel George Lewis *
John Frederick Tomashaska *	Ivar Goplen *
Ray Mello	Dorothy Beth Millman

* Those buried in Richland County

Justin W. Dake	Viola Cemetery
Richard E. Ryman	Richland Center Cemetery
George Earl Brainard	Bear Valley Cemetery
Pearl B. Waldsmith	Richland Center Cemetery
Floyd Willard Manley	Richland Center Cemetery
Frank M. Walsh	St. Mary's - RCtr Cemetery
Kenneth N. Cunningham	Rockbridge Cemetery
Hartzel P. Alderman	Haskins Cemetery
Howard E. Felton	Mill Creek Cemetery
William Shea	St. Bridget Cemetery
Carl Thomas Gunnill	Richland Center Cemetery
Jay Hollis Keys	Pine River Cemetery
Bayard C. DeHart	Richland Center Cemetery
Joseph Edward Jelinek	Cazenovia Cemetery
John L. McNamara	St. Bridget Cemetery
Hubert J. McNamara	St. Bridget Cemetery
Frank Kostka	Cazenovia Cemetery
Samuel George Lewis	East Pine River Cemetery
John Frederick Tomashaska	Richland Center Cemetery
Ivar Goplen	Five Points Cemetery

**List of all that Died in Service
& those buried in Richland Co.**



CHARLES WILLIAM NEWBERRY—(1)

Navy, U. S. Ship Wyoming; born September 26, 1896; son of Mr. and Mrs. Clinton Newberry.

FREDERICK ARTHUR DROUGHT—(2)

Private, Company G, 37th Infantry; born August 22, 1893; son of Arthur M. and Florence Drought.

THERON L. EWING—(3)

Private, Company A, 58th Engineers; born October 10, 1891; son of W. E. and Lezetta Ewing.

JOHN DONLEY—(4)

Private, Company G, 37th Infantry; born October 31, 1895; son of Mrs. Jodie Thompson and John H. Donley.

HARRY M. HUBRICK—(5)

Private, born at Avoca, Wis.; son of William and Helena Hubrick; gassed at battle of Chateau Thierry, August, 1918.

BERT E. JONES—(6)

Corporal, Company C, 121st Machine Gun Battalion, 32d Division; born August 13, 1892; son of Cash and Amelia Jones; promoted to Corporal summer of 1918.

HARRY W. FRANCISCO—(7)

Sergeant, Bat. E, 331st Field Artillery; born May 29, 1888; son of George and Fannie Francisco; promoted to Corporal November 6, 1917; to rank of Sergeant October 18, 1918.

JESSE M. BLIESNER—(8)

Private, Company D, 7th Infantry; born August, 1893; son of Gus and Ida Bliesner; wounded by explosion of bomb, August 10, 1918, while with 131st Infantry.

JOHN SIDNEY MALLO—(9)

Private; born January 22, 1890; son of Mr. and Mrs. Charles Mallo.

LAWRENCE N. SIPPY—(10)

Private, Company A, 6th Am. Train, A. E. F.; born March 17, 1895; son of W. I. and Jennie Sippy.

DEWEY L. LONG—(11)

Private, Bat. C, 26th Division, 102d Field Artillery, A. E. F.; born October 27, 1899; son of Henry A. and Lottie Long.

JAMES B. BREWER—(12)

Private, First Class; born January 25, 1894; son of Frank and Eva Brewer; promoted to First Class Private, March 1, 1918.

WALTER BEGLEY—(13)

Private; born August 25, 1894; son of John and Ella Begley; wounded at battle of Chateau Thierry, August 7, 1918; also on October 5, 1918.

HAROLD C. PUTZ—(14)

Seaman, Second Class, U. S. Navy; born February 7, 1895; son of Charlie and Annie Putz.

DAVID ZIMMERLEE—(15)

Private; born May 15, 1892; son of James and Rachel Zimmerlee; promoted to position of wagoner June 20, 1918.

OTTO JAMES HANZEL—(16)

Private; September 23, 1896; son of Joseph and Mary Hanzel.

CHARLES WILLIS JONES—(17)

Private, F. R. S. 314; born January 18, 1895; son of Fred and Mary Jones.

FRED BORTON—(18)

Private; born April 22, 1891; son of Benjamin and Carolyn Borton.

LOUIS SALOUTOS, (Louie the Greek)—(19)

Cook, Salvage Unit 304, A. E. F.; born May 28, 1894; son of Harrison and Catharina Saloutos.

HUGHIE J. ZIERFUSS—(20)

Private, First Class; born August 21, 1892; son of Andrew and Mary Zierfuss.

WORLD WAR II

NEWS OF OUR
MEN AND WOMEN
IN SERVICE

RICHLAND COUNTY
WISCONSIN



*A Scrapbook Collection
by
Mariel Beeman Kepler*

Here Are The Five Paulsons



ROBERT, MERLIN, DONALD, ROGER AND HAROLD

Cut Courtesy Wisconsin State Journal

Richland county now has a second family of five brothers serving their country, the Paulsons of the Excelsior community. The family achieved this honor with the youngest brother, Merlin's induction in February. First family of five was the Staum brothers of Boaz.

A letter from Robert to the Democrat this week tells that he and Roger see each other often. Robert tells of his arrival in Egypt in November, and it is to be presumed they are

now both serving in Africa. Robert is a private first class and Roger a corporal. Both have been overseas a year.

Sgt. Harold Paulson is an airplane mechanic at George Field, Lawrenceville, Ill. Promotion to corporal and sergeant for him have come since November. He has been in service since November, 1941.

Pfc. Donald Paulson is with an ordnance company training near Stockton, Calif.

Fireman Lawrence Cross is home on a 30-day leave, and he reports a thrilling experience on a destroyer. He tells that while on the way to Salerno a torpedo struck the ship, and that as it sank one of its own depth charges exploded, causing quite a loss of life among the crew. He was one of the men saved, but that rescue took place after he had been in the water for many hours, and all of his clothing and personal belongings were lost. The rescued men were taken to Palermo, later to Bizerte and Casablanca, and then a troop ship brought them to New York. All new clothing has been issued, and he will be back in New York by the 23rd to be reassigned.

Marine Private 1/c Wm. F. Tanner of West Mill street, Richland Center, recently completed a special course in the Radio Operators' school, conducted by the Signal Battalion at the Marine Corps Base, San Diego, Calif.

Mrs. Frankie Hole of Sextonville has received several letters from her son Lisle who is now in England. Lisle is an assistant gunner on a Flying Fortress.



COLLINS

Cut Courtesy Wisconsin State Journal

Having completed three years of service in the Marine Corps, on Dec. 10th, Paul J. Collins, son of the Leo Collinses, 847 North Church street, now can include himself in the ranks of veteran servicemen. He enlisted in 1940, and finished his boot training Jan. 24, 1941. After a leave at home he shipped out of San Diego for Pearl Harbor March 9, 1941, and served on one ship for 2½ years. Some of his work was very much a secret but he has been able to tell of escorting convoys to the Midway Islands and of witnessing the killing of thousands of gooney birds which are thick on those islands, so that the building of air bases could be begun. About six months ago Collins, who is a coxswain, was transferred to a mine sweeper.

-v-

World War II Scrapbook by Mariel Beeman Kepler



Military Style of Markers





Military Flag Holders for Wars and Organizations





**Military Service
with
Civilian Markers**



Pleasant Ridge - Bloom Township



Woodstock

CEMETERY MEMORIALS TO VETERANS

<http://www.richlandveteransmemorial.com/>



Richland County Veterans Memorial



^ ANIMALS YOU MEET AT & AROUND THE CEMETERIES ^

v BURIED MARKERS >>







OCCUPATIONS





Play on WORDS





2008-09-25 Richland County Sheriff's Report

FANCY CREEK CEMETERY

- Steven D. Chupp, sexton for the Fancy Creek Cemetery, reported that, sometime prior to Sept. 20, someone took veterans' flag holders from the cemetery. Missing were 16 from World War II and two from World War I.



**ACCIDENTS,
MISHAPS,
VANDELS & THIEFS**



Richland County, WI Cemeteries WI Cemeteries

<http://freepages.genealogy.rootsweb.ancestry.com/~richlandwi>

reb.ancestry.com/~richlandwi



Richland County, WI Cemeteries

This page updated: March 13, 2010

What's New

[Click this link to see What's New](#)

Richland Observer Obituary Index

[Click this link for 1970-ToDate Obit Index](#)

Richland County & Related Research Links

[Click this link for other Links](#)

[Richland County Cemeteries Additional Information](#) New January 13, 2010

- [Ash Creek Cemetery](#)
- [Ash Ridge Cemetery](#) AKA Putnam Cemetery
- [Bailey-Lowry Plot](#)
- [Basswood Cemetery](#)

- [Pleasant Ridge Cemetery - Bloom](#)
- [Pleasant Ridge Cemetery - Willow](#)
- [Pugh Plot](#)
- [Richland Center Cemetery](#) (With Photographs)
- [Richland City Cemetery](#)

- [Woodstock Cemetery](#)
- [Wright Plot](#) AKA Cox, Upper Byrds Creek and Woodland Plot
- [UNKNOWN \(cemetery not listed\) & Various burial Sites in Richland County, WI](#)

0642 15

since September 25, 2001

PICO
SEARCH

Search

[Site Search by PicoSearch. Help](#)

Email Corrections/Additions to: dthompso@mwt.net



Free Web space
provided by
RootsWeb

Use, Copyright and Ownership: Individuals and groups can use these volumes freely but without use for their financial gain. The full ownership is retained by the author.

Thompson's Richland County, Wisconsin Cemeteries

What's New

This page will list the date I uploaded major changes to my various Richland County cemeteries and the type of change. This should help guide you since your last visit.

Smaller changes are made on weekly and sometimes daily bases and are not listed on this page, but check the "Last Updated" date listed on each webpage for last update.

Dave Thompson

March 18, 2010 - Added 12 new people, 8 General Photographs, Cemetery Sign photo and updated general data, along with [HERE THEY SLEEP & TALES THE TOMBSTONES TELL](#) for the [Lone Rock Cemetery](#).

March 13, 2010 Added [HERE THEY SLEEP, TALES THE TOMBSTONES TELL](#) and uploaded the photographs to the [Jennings Cemetery](#).

February/March 2010 - I have completed 60 cemeteries with the [HERE THEY SLEEP](#) and the [TALES THE TOMBSTONES TELL](#) link on each of these Cemeteries, with approx. 40 more to complete yet.

February/March 2010 - Reviewed and cross referenced the 3,300 plus listed veterans in my Cemetery database with the Richland County Veterans Memorial project list. Then provided to Loretta McCarthy any of the ones in my list not presently on their list, along with supporting information. For more information on the Richland County Veterans Memorial project see their webpage at the following link:

<http://www.richlandveteransmemorial.com/>

January 30, 2010 - Updated data and added 6 new records using the photos from the US GEN WEB ["Tombstone Photograph Pages"](#) for Richland Co, WI for the [Hopewell Cemetery](#).

January 29, 2010 - Updated data and added 29 new records using the photos from the US GEN WEB ["Tombstone Photograph Pages"](#) for Richland Co, WI for the [Felton Cemetery](#).

January 16, 2010 - Added a ["Cemetery Burial Numbers"](#) which list a Map key number, the cemetery name, Township, original number of burials recorded before my cemetery project, the number listed to the end of 2009, the name of the 1st recorded burial and the year of the last recorded burial (Up to 2010). Also I have added ["Cemetery Location Map"](#) to show the general location of the listed cemeteries. Both under the [Richland County Cemeteries Additional Information](#).



Dave Thompson's

The Richland Observer Obituary Index

1970 to **TODATE**

Last Updated April 9, 2010

Total of 13,950 records

Click Surname Letter

[A](#) [B](#) [C](#) [D](#) [E](#) [F](#) [G](#) [H](#) [I](#) [J](#) [K](#) [L](#) [M](#)
[N](#) [O](#) [P](#) [Q](#) [R](#) [S](#) [T](#) [U](#) [V](#) [W](#) [X](#) [Y](#) [Z](#)

Obit names starting with T

Dates are year-month-day

*Indicates another source for listed information then obit.

Last Updated: January 22, 2010

Name	Birth date	Death date	Maiden Name	Obit Issue	Mother's maiden
Tackett, Clara Geneva "Gene"	1908/03/10	2000/02/10	Durham	2000/02/17	Slade
Tackett, Ralph	1899/12/02	1989/10/28		1989/11/02	Smith
Tadder, Arliss G. "Art"	1940/01/14	1993/08/16		1993/08/19	Sandmire
Tadder, Arnold K.	1930/09/09	2003/12/19		2003/12/25	Anderson
Tadder, Clifford	1908/08/12*	1971/10/02		1971/10/07	Anderson*
Tadder, Corliss "Corky"	1938/06/15*	2009/05/18		2009/05/21	Sandmire*
Tadder, Dorothy B.	1903/12/13	1996/09/09	Anderson	1996/09/12	Starrett
Tadder, Lawrence D.	1927/04/07	2005/10/19		2005/10/27	Anderson
Tadder, Marvin E.	1924/08/14	2006/07/05		2006/07/13	Anderson
Tadder-Huff, Minnie H.	1907/04/09	1992/11/21	Phetteplace	1992/12/03	Johnson
Taft, Donald J., Dr.	1912/05/27	1995/04/09		1995/04/13	Ulrich
Taft, Genevieve D.	1907/02/09	1995/02/23	Dufort	1995/03/02	

Richland County, WI and Related Research Links

(Last Updated February 18, 2010)

Click on the Links Below

AHGP-Wisconsin-Richland County - hosted by Tim Stowell

<http://www.rootsweb.com/~wirichla/>

Richland County, WI Genealogy and History - by Lori Manning

<http://www.MonticelloWi.com/RichlandCo/>

The Hills and Hollows of Richland - By Dennis Cook

<http://freepages.genealogy.rootsweb.com/~djns/Homepage.html>

The Richland County History Room - Historians: Crystal & Nita

<http://freepages.history.rootsweb.ancestry.com/~richlandcowi/index.htm>

Richland County Wisconsin Newspaper Index - By Margaret Jordan

<http://www.tc.umn.edu/~jorda014/>

Richland Center City Government Home Page

<http://www.ci.richland-center.wi.us/>

Richland County Government Home Page

<http://www.co.richland.wi.us/>

**Richland County Government - Register of Deeds
(Includes On-Line Vital Records Application & Fees)**

<http://www.rclrs.net/rod/default.asp>

Richland County Vereran's Memorial

**Honoring Those Who Have Served, Those Who Are Serving
And Those Who Will Serve**

<http://www.richlandveteransmemorial.com/>

State Historical Society of Wisconsin - Civil War Vets & Units

<http://www.wisconsinhistory.org/roster/search.asp>

Sons of the Union Veterans of the Civil War

<http://www.suvcwdb.org/home/index.php>

[USGEN Web -Wisconsin Tombstone Transcription](#)

[USGEN Web- Wisconsin Tombstone Transcription Project - Richland Co.](#)

[USGEN Web -Wisconsin Tombstone Photograph Pages](#)

[USGEN Web- Wisconsin Tombstone Photograph Pages - Richland Co.](#)



Richland County, WI Cemeteries Additional Information

Last updated: January 16, 2010

[Richland County Cemeteries - Cemetery Burial Numbers {Includes Map Key}](#)

[Richland County Cemeteries - Cemetery Map Locations {Use Burial for key}](#)

[Richland County Cemeteries - Cemetery Names and Their Aliases](#)

[Richland County Cemeteries - Summary of Veterans by War](#)

Richland County, WI Cemeteries Burial Numbers

Map#	CEMETERY NAME	TOWNSHIP	1975 Burials	To 2010 Burials	1st Burial	Name of first buried.	Last Burial
1	Ash Creek	ORION	220	312	1860	Helena Neefe	2009
2	Ash Ridge	MARSHALL	80	153	1881	Myrtie Talledge	2009
3	Bailey-Lowry	MARSHALL	2	5	1850	Mary Bailey	1877
4	Basswood	EAGLE	904	1541	1855	George Fazel	2009
5	Bear Valley	BUENA VISTA	349	492	1845	Benjamin Dixon	2009
6	Bender (Old Hopewell)	FOREST	144	151	1851	Austin Bender	1968
7	Bethel	EAGLE	28	36	1860	John Pickering	1979
8	Big Willow	WILLOW	64	97	1862	Herbert Carpenter	2008
9	Bloom City	BLOOM	703	934	1856	Louisa Cooper	2009
10	Boaz	DAYTON	221	308	1860	Nancy Curless	2009
Total of all records			17606	36402			

Richland County, WI Cemetery Names and their Aliases

Last updated: January 13, 2010

Anher Plot
 Ash Creek Cemetery
 Ash Ridge Cemetery
 Bailey-Lowry Plot
 Basswood Cemetery
 Bear Valley Cemetery
 Bender Cemetery
 Bethel Cemetery
 Big Willow Cemetery
 Bloom City Cemetery
 Boaz Cemetery
 Booher Cemetery

See: Neher Plot

Richland County WI Cemeteries



SCHMITT WOODLAND HILLS

April 13, 2010

A Richland County WI
Cemeteries Presentation

By David Thompson